



US007025934B2

(12) **United States Patent**  
**Zimmermann**

(10) **Patent No.:** **US 7,025,934 B2**

(45) **Date of Patent:** **Apr. 11, 2006**

(54) **APPARATUS FOR TISSUE PROCESSING FOR THE TISSUE EMBEDDING AND MOUNTING FOR THE PROCESSING CONTAINERS FOR TISSUE PROCESSING**

(58) **Field of Classification Search** ..... 422/64, 422/68.1, 63, 915, 917, 941, 945; 198/414; 436/45, 64, 65; 211/78, 81, 163

See application file for complete search history.

(75) **Inventor:** **Michael Zimmermann**, Leopoldsdorf (AT)

(56) **References Cited**

U.S. PATENT DOCUMENTS

(73) **Assignee:** **Leica Mikrosysteme GmbH**, Vienna (AT)

4,688,517 A \* 8/1987 Hollman ..... 118/421  
5,180,606 A \* 1/1993 Stokes et al. .... 427/2.13  
5,389,339 A \* 2/1995 Petschek et al. .... 422/64

(\*) **Notice:** Subject to any disclaimer, the term of this patent is extended or adjusted under 35 U.S.C. 154(b) by 653 days.

\* cited by examiner

*Primary Examiner*—Jill Warden

*Assistant Examiner*—Paul Hyun

(74) *Attorney, Agent, or Firm*—Simpson & Simpson, PLLC

(21) **Appl. No.:** **10/100,849**

(22) **Filed:** **Mar. 18, 2002**

(57) **ABSTRACT**

(65) **Prior Publication Data**

US 2002/0185391 A1 Dec. 12, 2002

An apparatus (1) for tissue preparation for the tissue embedding, having a transport plate (15) defining a circumferential edge (15c). At the circumferential edge (15c) several recesses (16) are formed, each of which comprises a plurality of several circular cut outs (16a) being arranged so that it has an opening into the direction of the circumferential edge (15c). The transport plate (15) is surrounded by a housing (5) which defines an inner upper side (8a) on which a heating and cooling device (3) is provided.

(30) **Foreign Application Priority Data**

Mar. 22, 2001 (EP) ..... 01107115

(51) **Int. Cl.**

**B05C 3/02** (2006.01)

**B01L 3/00** (2006.01)

**G01N 35/00** (2006.01)

(52) **U.S. Cl.** ..... 422/64; 118/423

**5 Claims, 4 Drawing Sheets**

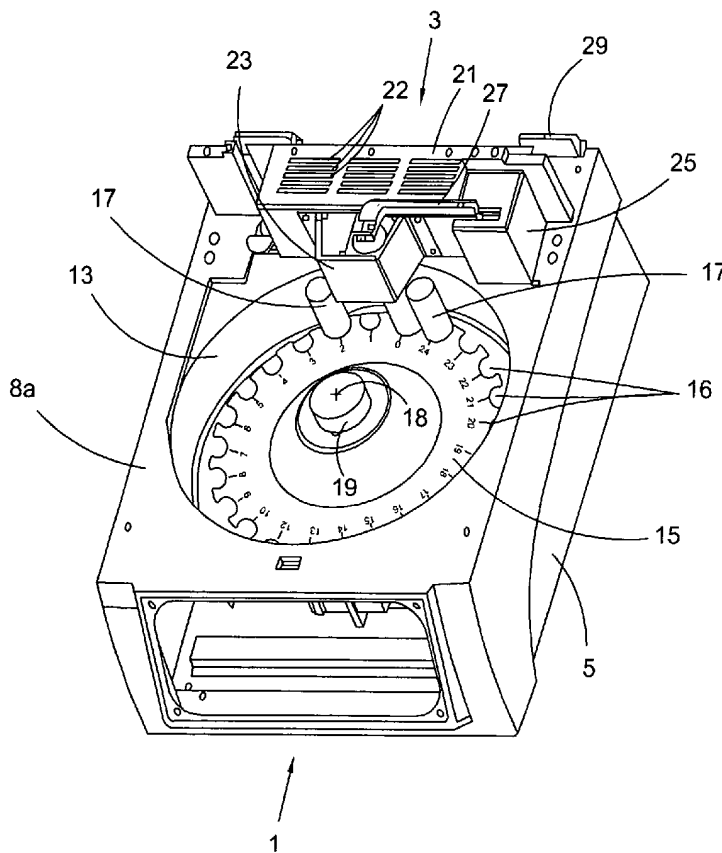

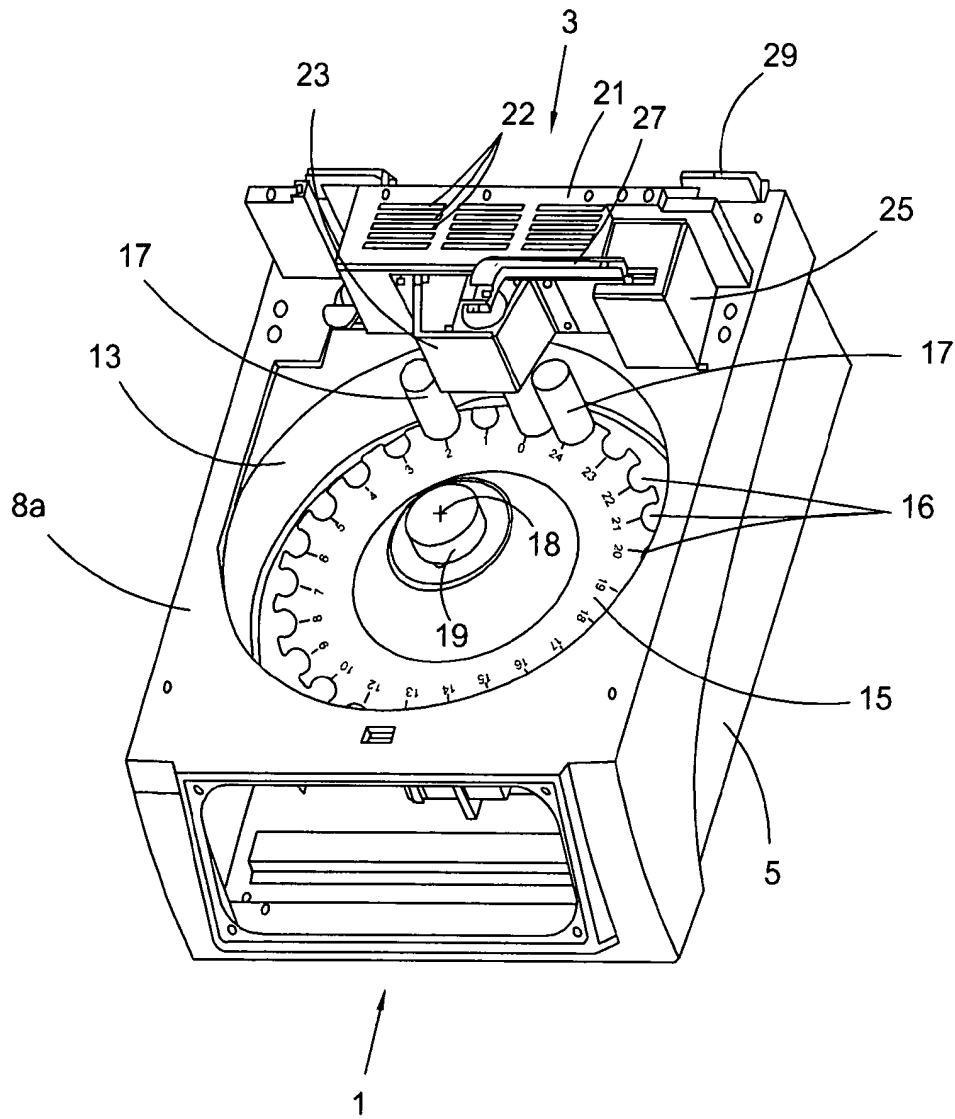

Fig. 1

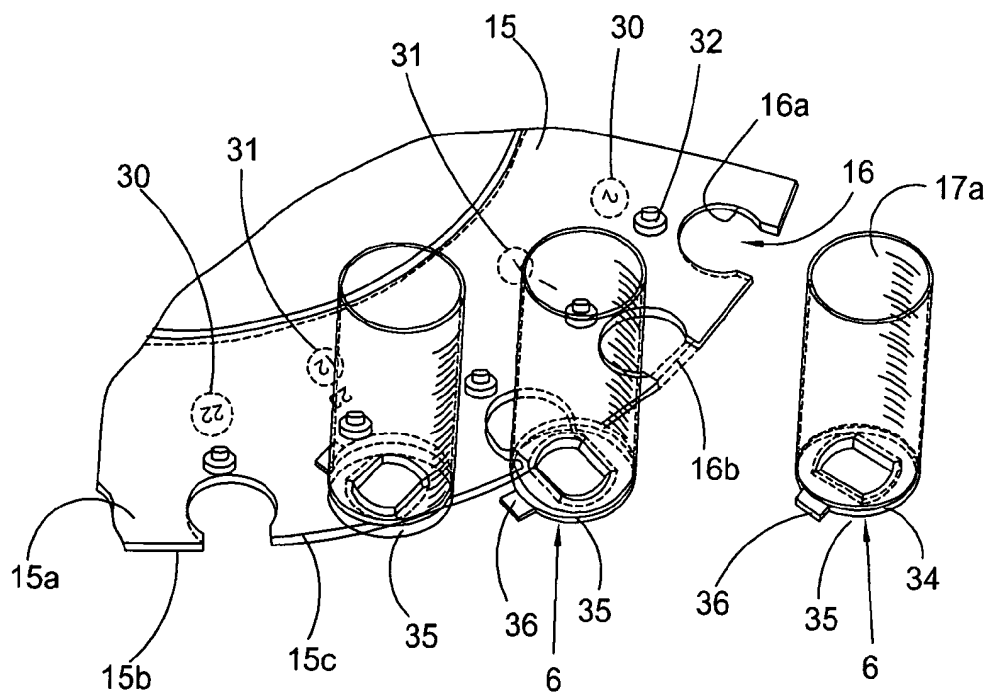

Fig. 2

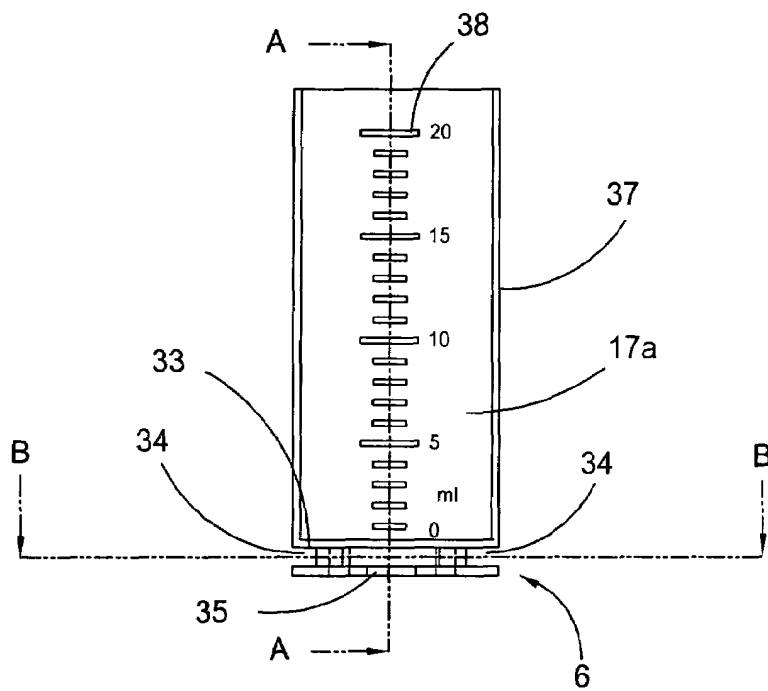

Fig. 3a

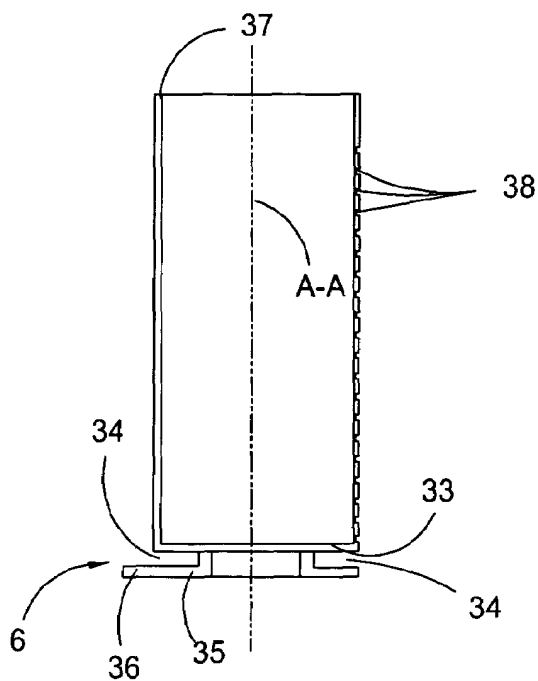

Fig. 3b

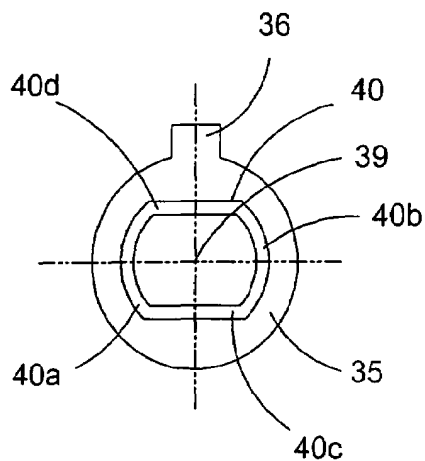

Fig. 3c



1

**APPARATUS FOR TISSUE PROCESSING  
FOR THE TISSUE EMBEDDING AND  
MOUNTING FOR THE PROCESSING  
CONTAINERS FOR TISSUE PROCESSING**

CROSS REFERENCE TO RELATED  
APPLICATIONS

This invention claims priority of the European patent application 01 107 115.6, filed Mar. 22, 2001, which is incorporated by reference herein.

FIELD OF THE INVENTION

The invention concerns an apparatus for tissue processing for the tissue embedding. Moreover, the invention concerns a mounting for processing containers for tissue processing.

BACKGROUND OF THE INVENTION

The U.S. Pat. No. 4,688,517 discloses an apparatus for processing tissue samples. On a rotatable plate a plurality of processing containers is provided for the sample processing. The plate is rotatable, so that the processing containers can be transported to a processing station at which the tissue samples are successively immersed into different processing liquids. For a suitable tempering of the actually used processing liquids a heating and cooling device is permanently mounted to the housing of the apparatus. The plate is not only rotatable but also raisable and lowerable in the direction of the axle. The processing containers are only snapped into recesses of the transport plate. A firm and defined placement of the processing containers on the plate is not provided.

SUMMARY OF THE INVENTION

It is an object of the invention to provide an apparatus for tissue processing for the tissue embedding which allows a simple and secure handling of the tissue preparation for the tissue embedding.

The above object is solved by an apparatus which comprises:

- a transport plate defining a circumferential edge;
- a plurality of recesses formed in the circumferential edge recesses formed therein, wherein each recess has the form of a circular cut out being so arranged that it has an opening into the direction of the circumferential edge;
- a housing which surrounds the transport plate, wherein the housing defines an inner upper side;
- a heating- and cooling device provided on the inner upper side;
- an indent assigned to each recess; and
- a processing container cooperates with the indent so that a firm and defined placing of each processing container on the transport plate is achieved.

It is a further object of the invention to provide a mounting for the processing containers for tissue processing which comprises:

- a mounting element formed on a bottom of the processing container, wherein the mounting element cooperates with a transport plate defining a circumferential edge;
- a nose formed at the mounting element; and
- an indent at the transport plate, wherein the nose cooperates with the indent when the processing container is in the mounted state.

2

The above object is solved by a mounting which is characterized in that a nose is formed at the mounting element, wherein the nose stops in the mounted state of the processing container at an indent at the transport plate.

An advantage of the invention is that by the special design of the processing containers and of the transport plate a firm fit of the processing containers is achievable. This firm and defined fit is absolutely necessary for the trouble free tissue processing. The rotation of the transport plate and the raising and lowering of the transport plate make it absolutely necessary, that the processing containers are inserted into the accommodations without cant or touching.

The accommodations are provided with a heating and cooling device which can easily be exchanged, so that the user can switch in a simple manner between processing containers of different sizes. This is of advantage if large pieces of tissue for the tissue embedding must be processed. In addition, the possibility to pivot the heating and cooling device simplifies the replacement of the entire transport plate substantially easier. The heating and cooling device will thus be lifted away from the free space in the housing. It is not necessary that individual processing containers must be removed from the transport plate in order to enable the replacement. The replacement of the heating and cooling device can be executed particularly easily. For this the pins are to be removed from the hinges and subsequently the entire heating and cooling device is removed. A coding is transmitted to the control unit in the housing, which controls the rotating and the lifting motion of the transport plate accordingly. With the different heating and cooling devices the accommodations for the processing containers are of various sizes and each permanently connected to a power supply for the heating and cooling device. In an embodiment of the invention the accommodation for the processing containers is designed in such a way that a first and a second chamber for the processing containers are provided, whereby the second chamber has a cover. The first chamber serves for tempering the processing liquid in the processing container and for immersing the tissue sample into the processing container. The second chamber can be used for preheating the processing liquid in the processing container. The cover prevents an unnecessary evaporation of the processing liquid.

The indent at the transport plate close to the recesses has the advantage that a defined stop is achievable for the processing containers. The processing containers have a distance element which can be inserted with its narrow side through the openings at the edge of the transport plate. By rotating the processing containers inside of the circular cut out a firm placing is achieved within the recess. The rotating motion is limited in that the nose at the processing container cooperates with the indent on the transport plate.

It is additionally advantageous that the different types of the processing containers have an identical mounting element for attaching the processing containers to the transport plate. The mounting element is symmetrically arranged around the centre of a processing container. The mounting element comprises a first and a second circle segment and a first and a second bridge. The first and the second bridge are separated by a distance from each other, which is essentially the size of the opening of the recess at the edge of the transport plate. The diameter of the first and the second circle segment is essentially the same as the diameter of the recess.

## BRIEF DESCRIPTION OF THE DRAWINGS

In the drawing the invention is schematically shown and described on the basis of the figures below. The figures show in:

FIG. 1a perspective view of the apparatus for tissue processing for the tissue embedding;

FIG. 2a perspective partial view of the transport plate together with the processing containers for the tissue embedding;

FIG. 3a a side view of a small processing container;

FIG. 3b a cross sectional view of the small processing container taken along line A—A of FIG. 3a;

FIG. 3c a cross sectional view of the small processing container taken along line B—B of FIG. 3a;

FIG. 4a a side view of a large processing container;

FIG. 4b a cross sectional view of the large processing container taken along line A—A of FIG. 4a;

FIG. 4c a cross sectional view of the large processing container taken along line B—B of FIG. 4a

## DETAILED DESCRIPTION OF THE INVENTION

FIG. 1 shows a perspective view of the apparatus 1 for tissue processing for the tissue embedding without a cover (not shown) provided for the apparatus 1. The housing 5 has formed an inner upper side 8a in which a free space 13 is provided which allows access to the inside of the apparatus 1. By the free space 13 access to the transport plate 15, that is arranged inside the housing 5, is possible. The transport plate 15 is configured in this embodiment in a circular shaped manner and possesses at its edge a plurality of recesses 16, which serve for the accommodation of processing containers 17. On the transport plate 15 processing containers 17 of different size can be mounted. The transport plate 15 is freely rotatable around an axle 18 and can be raised and lowered additionally in the direction of the axle 18. The transport plate 15 is secured by means of a securing element 19. With the housing 5 a heating and cooling device 3 is connected. The heating and cooling device 3 consists of a power supply 21 which is provided with several vent openings 22, for venting off the produced heat. To the power supply 21 an accommodation 23 for the processing containers 17 is attached which is arranged in such a manner that it projects at least partly into the area of the free space 13. As already mentioned above the transport plate 15 can be raised and lowered in the direction of the axle 18. In the raised status at least one processing container 17 is in the accommodation 23 and can be kept in an appropriate way at a specific temperature. The processing containers 17 contain different liquids which are necessary for processing of the tissue samples. Beside the heating and cooling device 3 a mechanic 25 is provided to which an arm 27 is connected. At the arm 27 a tissue sample (not shown) is attached, which is submitted to an appropriate sample processing program. The arm 27 can move up and down whereby the tissue sample is dipped into the liquid, which is in the processing container 17 being in the accommodation 23 at the moment. To the housing 5 hinge elements 29 are connected with which the cover (not shown) can be pivoted. As already mentioned above small processing containers 17a and large processing containers 17b can be used. With respect to the size of the processing container the accommodation 23 is designed.

A partial view of the transport plate 15 is shown in FIG. 2. Hereby the cooperation of the processing container 17

with the transport plate 15 is shown as well. The transport plate 15 comprises an upper side 15a and an under side 15b. On the upper side 15a of the transport plate 15 a first set of numbers 30 is provided directly opposite to the recesses 16. A second set of numbers 31 is provided on the upper side 15a of the transport plate 15 such that every second recess 16 a number is assigned. The first set of numbers 30 is assigned to the small processing containers 17a (as shown as well in FIG. 2) and the second set of numbers 31 is assigned to the large processing containers 17b. Between the first set of numbers 30 and the recess 16 an indent 32 is formed in the transport plate 15, wherein the indent 32 forms a protrusion on the under side 15b of the transport plate 15. The recess 16 comprises a circular cut out 16a, which has at the circumferential edge 15c of the transport plate 15 an opening 16b, wherein the opening 16b is smaller than the diameter of the recess 16. Preferably, the processing containers 17 are of cylindrical shape and possess at a bottom 33 a circumferential notch 34, which has approximately the thickness of the circumferential edge 15c of the transport plate 15. The notch 34 is terminated at the side opposite to the bottom 33 with a circular disk 35. At the circular disk a nose 36 is formed which cooperates with the indent 32 on the under side 15b of the transport plate 15.

A side view of the small processing container 17a is shown in FIG. 3a. The small processing container 17a has a cylindrical wall 37 which is covered by a bottom 33. On a part of the cylindrical wall 37 a scale 38 is provided. In this embodiment the scale 38 is pressed into the cylindrical wall 37 of the small processing container 17a. At the bottom 33 a mounting element 6 is formed for holding the processing containers 17 to the transport plate 15. All processing containers 17 have the same mounting element 6. Between the bottom 33 and a circular disk 35 the circumferential notch 34 is formed. In FIG. 3b the small processing container 17a is shown in a cross sectional view along line A—A. The bottom 33 and the disk 35 are separated by the notch 34 so that the distance between the bottom 33 and the notch 34 is approximately the thickness of the edge 15c of the transport plate 15.

FIG. 3b shows a cross sectional view through the small processing container 17a along line A—A as shown in FIG. 3a. The circular disk 35 possesses at one position a larger diameter. At this position of the circular disk 35 a nose 36 is formed. In FIG. 3c a view of the small processing container 17a along line B—B is shown and clearly shows the shape of a distance element 40 which is formed between the bottom 33 of the processing container 17a and the circular disk 35 by the notch 34. The distance element 40 is arranged symmetrically around the centre 39 of the small processing container 17a. In the embodiment shown here the distance element 40 comprises a first and a second circle segment 40a and 40b which are opposite to each other. The first and the second circle segment 40a and 40b are connected with each other by a first and a second bridge 40c and 40d, wherein the first and the second bridge 40c and 40d are parallel to each other.

In the FIGS. 4a to 4c the embodiment of a large processing container 17b is shown. All features which are identical with the features as shown in FIGS. 3a to 3d are marked with the same reference numeral. The large processing containers 17b possess the same height as the small processing containers 17a, but differ in diameter. Accordingly, the large processing containers 17b can take up more processing liquid or treat larger tissue samples for processing. As mentioned above the cylindrical wall 37 of the large processing containers 17b is closed with a bottom 41 of a large diameter.

As well the circular disk 35 and the circumferential notch 34 are provided adjacent to the bottom 41. The view, as shown in FIG. 4c, clearly indicates that the distance element 40 and the circular disk 35 are dimensioned in the same way as shown in FIG. 3c. This is logical, since the small and the large processing containers 17a and 17b are mounted to the transport plate 15 with the same recess 16.

Moreover, the heating and cooling device 3 (FIG. 1) is exchangeable. This is necessary for the use of different processing containers 17. With the use of large processing containers 17b the accommodation 23, connected to the power supply 21, has to be designed for the reception of the large processing containers 17b as well. To do so, the heating and cooling device 3 can be lifted off in a simple manner and exchanged by another one. Additionally, the heating and cooling device 3 is connected to the inner upper side 8a of the housing 5 by at least one hinge (not shown) in a pivotable manner with the apparatus 1.

The invention was described with respect to a specific embodiment of the invention form. It is however obvious that changes and modifications can be carried out without leaving the scope of protection of the claims below.

PARTS LIST	
6	apparatus
3	heating and cooling device
5	housing
6	mounting element
8a	inner upper side
13	free space
14	cut out
15	transport plate
15a	upper side
15b	under side
15c	circumferential edge
16	recess
16a	circular cut out
16b	opening
17	processing container
17a	small processing container
17b	large processing container
18	axle
19	securing element
21	power supply
22	vent opening
23	accommodation
25	mechanic
27	arm
29	hinge element
30	first set of numbers
31	second set of numbers
32	indent
33	bottom
34	circumferential notch
35	circular disk
36	nose
37	cylindrical wall
38	scale
39	centre
40	distance element
40a	first circle segment
40b	second circle segment

-continued

PARTS LIST		
5	40c	first bridge
	40d	second bridge
	41	bottom
	A—A	line
	B—B	line

What is claimed is:

1. An apparatus for tissue preparation for the tissue embedding, comprises:

- a transport plate defining a circumferential edge;
- a plurality of recesses formed in the circumferential edge, wherein each recess has the form of a circular cut out being so arranged that it has an opening into the direction of the circumferential edge, wherein large processing containers and small processing containers having an identical mounting element are mountable in the recesses on the transport plate, wherein a processing container is firmly and definably mounted onto the transport plate by sliding the mounting element into the recess and further cooperating the processing container with an indent assigned to each recess;
- a first and a second set of numbers assigned to the recesses so that the first set of numbers is covered by the large processing containers mounted in the recesses;
- a housing which surrounds the transport plate, wherein the housing defines an inner upper side; and
- a heating- and cooling device provided on the inner upper side.

2. The apparatus as defined in claim 1, wherein by the use of the large processing containers in comparison with small processing containers maximally only the half amount of large processing containers is mountable on the transport plate.

3. The apparatus as defined in claim 1, wherein at least one hinge element is provided on the heating and cooling device at a side, which is opposite to an accommodation for the processing containers attached to the heating and cooling device, whereby the heating and cooling device is pivotable so that the transport plate can be lifted out from the housing.

4. The apparatus as defined in claim 1, wherein the mounting element is symmetrically arranged around a centre of the processing container.

5. The apparatus as defined in claim 3, wherein the mounting element comprises a first and a second circle segment, a first and a second bridge connecting the first and the second circle segment, wherein the first and the second bridge are separated by a distance from each other which is essentially of the size of an opening of the recess formed at the edge of the transport plate, and the diameter of the first and the second circle segment is essentially of the diameter of the recess.

\* \* \* \* \*